

151 SURVEY DRAWING

1. LINES AND BOUNDS DESCRIPTION

Reference is made to the plat of the Survey of the East 1/2 of Section 16, Township 12N, Range 10E, County of Hamilton, Ohio, as shown on the attached plat, and to the plat of the Survey of the East 1/2 of Section 16, Township 12N, Range 10E, County of Hamilton, Ohio, as shown on the attached plat, and to the plat of the Survey of the East 1/2 of Section 16, Township 12N, Range 10E, County of Hamilton, Ohio, as shown on the attached plat, and to the plat of the Survey of the East 1/2 of Section 16, Township 12N, Range 10E, County of Hamilton, Ohio, as shown on the attached plat, and to the plat of the Survey of the East 1/2 of Section 16, Township 12N, Range 10E, County of Hamilton, Ohio, as shown on the attached plat, and to the plat of the Survey of the East 1/2 of Section 16, Township 12N, Range 10E, County of Hamilton, Ohio, as shown on the attached plat, and to the plat of the Survey of the East 1/2 of Section 16, Township 12N, Range 10E, County of Hamilton, Ohio, as shown on the attached plat, and to the plat of the Survey of the East 1/2 of Section 16, Township 12N, Range 10E, County of Hamilton, Ohio, as shown on the attached plat, and to the plat of the Survey of the East 1/2 of Section 16, Township 12N, Range 10E, County of Hamilton, Ohio, as shown on the attached plat, and to the plat of the Survey of the East 1/2 of Section 16, Township 12N, Range 10E, County of Hamilton, Ohio, as shown on the attached plat, and to the plat of the Survey of the East 1/2 of Section 16, Township 12N, Range 10E, County of Hamilton, Ohio, as shown on the attached plat, and to the plat of the Survey of the East 1/2 of Section 16, Township 12N, Range 10E, County of Hamilton, Ohio, as shown on the attached plat, and to the plat of the Survey of the East 1/2 of Section 16, Township 12N, Range 10E, County of Hamilton, Ohio, as shown on the attached plat, and to the plat of the Survey of the East 1/2 of Section 16, Township 12N, Range 10E, County of Hamilton, Ohio, as shown on the attached plat, and to the plat of the Survey of the East 1/2 of Section 16, Township 12N, Range 10E, County of Hamilton, Ohio, as shown on the attached plat, and to the plat of the Survey of the East 1/2 of Section 16, Township 12N, Range 10E, County of Hamilton, Ohio, as shown on the attached plat, and to the plat of the Survey of the East 1/2 of Section 16, Township 12N, Range 10E, County of Hamilton, Ohio, as shown on the attached plat, and to the plat of the Survey of the East 1/2 of Section 16, Township 12N, Range 10E, County of Hamilton, Ohio, as shown on the attached plat, and to the plat of the Survey of the East 1/2 of Section 16, Township 12N, Range 10E, County of Hamilton, Ohio, as shown on the attached plat, and to the plat of the Survey of the East 1/2 of Section 16, Township 12N, Range 10E, County of Hamilton, Ohio, as shown on the attached plat, and to the plat of the Survey of the East 1/2 of Section 16, Township 12N, Range 10E, County of Hamilton, Ohio, as shown on the attached plat, and to the plat of the Survey of the East 1/2 of Section 16, Township 12N, Range 10E, County of Hamilton, Ohio, as shown on the attached plat, and to the plat of the Survey of the East 1/2 of Section 16, Township 40.0

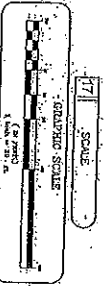
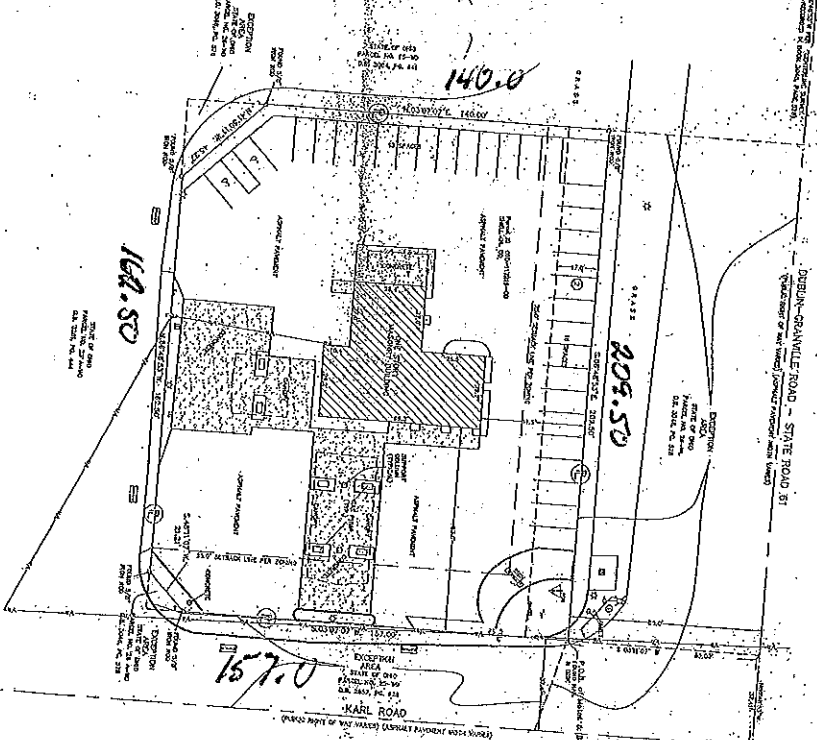

Surveyor's Seal
 National Surveying Company, Inc.
 225 Front Street, Cincinnati, Ohio
 201-421-1000

Sheet 2 of 2

151 SURVEY DRAWING

Client Address: _____

Project Name: _____

Project Location: _____

Survey Date: _____

Scale: _____

Drawn By: _____

Checked By: _____

Project Manager: _____

Company Name: _____

Address: _____

City: _____

State: _____

Zip: _____

Phone: _____

Fax: _____

Project Number: _____

Sheet Number: _____

2006 JUN 30 10:00 AM

1618

1585 E. DUBLIN-GRANVILLE ROAD
COLUMBUS, OH

BEING A 0.8129 ACRE (35,409 SQ.FT.) TRACT OF LAND SITUATED IN QUARTER TOWNSHIP 4, T. 2 W., R. 18 W., U.S. MILITARY LANDS, CITY OF COLUMBUS AND SHARON TOWNSHIP, FRANKLIN COUNTY, OHIO AND BEING MORE PARTICULARLY DESCRIBED AS FOLLOWS:

COMMENCING AT THE CENTERLINE INTERSECTION DUBLIN-GRANVILLE ROAD AND KARL ROAD; THENCE ALONG THE CENTERLINE OF DUBLIN-GRANVILLE ROAD N86°48'53"W (BEARING BASIS: N86°48'53"W PER "CENTERLINE SURVEY FRA-181-11.57"), A DISTANCE OF 37.41 FEET TO A CALCULATED POINT MARKING THE INTERSECTION OF THE CENTERLINE OF DUBLIN-GRANVILLE ROAD AND WESTERLY RIGHT OF WAY LINE OF KARL ROAD; THENCE S.03°11'07"W., A DISTANCE OF 80.00 FEET TO A FOUND NAIL & DISK, BEING THE INTERSECTION OF THE SOUTHERLY RIGHT OF WAY LINE OF DUBLIN-GRANVILLE ROAD AS RECORDED IN BOOK 3048, PAGE 578, AND THE WESTERLY RIGHT OF WAY LINE OF KARL ROAD AS RECORDED IN BOOK 2857, PAGE 626, SAID POINT BEING THE POINT OF BEGINNING;

THENCE ALONG SAID WESTERLY RIGHT OF WAY LINE OF KARL ROAD S.03°07'07"W., A DISTANCE OF 157.00 FEET TO A FOUND 5/8" IRON ROD;

THENCE S.48°11'07"W., ALONG THE NORTHWESTERLY SIDE OF STATE OF OHIO PARCEL NO. 26 A-WD, RECORDED IN DEED BOOK 3048, PAGE 578 OF SAID COUNTY RECORDS, A DISTANCE OF 21.21 FEET TO A FOUND 5/8" IRON ROD;

THENCE N.86°48'53"W., ALONG THE NORTHERLY SIDE OF STATE OF OHIO PARCEL NO. 23 A-WD, RECORDED IN DEED BOOK 3281, PAGE 444 OF SAID COUNTY RECORDS, A DISTANCE OF 162.50 FEET TO A FOUND 5/8" IRON ROD;

THENCE N.41°50'11"W., ALONG THE NORTHEASTERLY SIDE OF STATE OF OHIO PARCEL NO. 26-WD, RECORDED IN DEED BOOK 3048, PAGE 578 OF SAID COUNTY RECORDS, A DISTANCE OF 45.27 FEET TO A FOUND 5/8" IRON ROD;

THENCE N.03°07'07"E., ALONG THE EASTERLY SIDE OF STATE OF OHIO PARCEL NO. 25-WD, RECORDED IN DEED BOOK 3004, PAGE 641 OF SAID COUNTY RECORDS, A DISTANCE OF 140.00 FEET TO A FOUND 5/8" IRON ROD ON THE SOUTHERLY RIGHT OF WAY LINE OF DUBLIN-GRANVILLE ROAD;

THENCE S.86°48'53"E., ALONG SAID SOUTHERLY RIGHT OF WAY LINE OF DUBLIN-GRANVILLE ROAD, A DISTANCE OF 209.50 FEET TO THE POINT OF BEGINNING.

CONTAINING 35,409 SQUARE FEET OR 0.8129 ACRES, MORE OR LESS.

THE ABOVE DESCRIBED PROPERTY IS BASED ON A FIELD SURVEY PERFORMED ON 1-05-06 BY EARL STROM, RPS S-8316.

0-100-D
All of
(010)
117219

DATE:

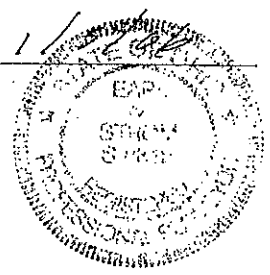

SURVEY & LEGAL DESCRIPTION BY:

Earl N. Strom
EARL N. STROM, RPS S-8316

